

# Golf Course Master Plan



SCORECARD				
BLUE	METRES	PAR	METRES	RED
1	135	3	125	1
2	465	5	435	2
3	534	4	284	3
4	467	5	389	4
5	297	4	206	5
6	380	4	353	6
7	349	4	270	7
8	175	3	160	8
9	332	4	292	9
CUT	2883	36	2554	OUT
10	180	3	145	10
11	165	3	135	11
12	270	4	266	12
13	300	4	280	13
14	250	4	200	14
15	452	5	430	15
16	140	3	130	16
17	395	4	350	17
18	170	3	150	18
IN	2353	30	2086	IN
CUT	2883	36	2554	OUT
TOTAL	5236	69	4040	TOTAL

## SUMMARY OF GOLF WORKS

- a** Hole 1 - 150m par 3  
Construct new teak, path and plant out entry road.
- b** Hole 8 - 175m par 3  
Potential to extend to a 265m par 4 to be reviewed in detail as part of future overall course master plan.
- c** Hole 10 - 150m par 3  
Bio-basin to be installed as part of resort budget. Construct new tees in conjunction with basin and cart path realignment.
- d** Hole 11 - 185m par 3  
Construct new green subject to resolution of bio-basin and subsequent detailed design.
- e** Hole 12 - 270m par 4  
Relocate new tees and add bunkers short of green to better suit short par 4 playing strategy.
- f** Hole 13 - 300m par 4  
Rebuild green in new location subject to detailed design.
- g** Hole 14 - 250m par 4  
Build new short par 4 hole with rock wall to retain green beside existing dam. (subject to detailed design).
- h** Hole 15 - 482m par 5  
Rebuild green and realign fairway to adjoin future 17th hole.
- i** Hole 16 - 140m par 3  
Construct new hole with a rock wall to retain the green on enlarged water body. (subject to detailed design).
- j** Hole 17 - 305m par 4  
Construct new hole. (subject to detailed design to minimize safety issues).
- k** Hole 18 - 170m par 3  
Construct new hole complete, extend existing ponds between new 17th green and 18th hole subject to detailed design.
- l** Construct new practice putting green. (subject to detailed design).

## LEGEND:

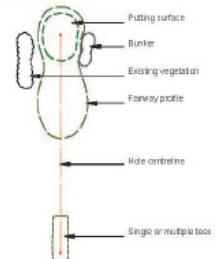

## EXISTING HOLE

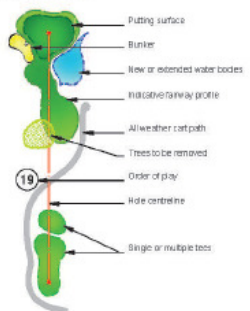

## PROPOSED HOLE

**GEMLIFE COOROY**  
**GOLF COURSE DRAFT MASTER PLAN 7**  
 SHOWING PROPOSED CHANGES TO COOROY GOLF CLUB

prepared by  
**GND**  
**GOLF DESIGN**  
 PIVULUB

email: graham@gndgolf.com.au  
 date: February 2020  
 drawing no: G288.MP.07

# Clubhouse and Carpark Site Plan

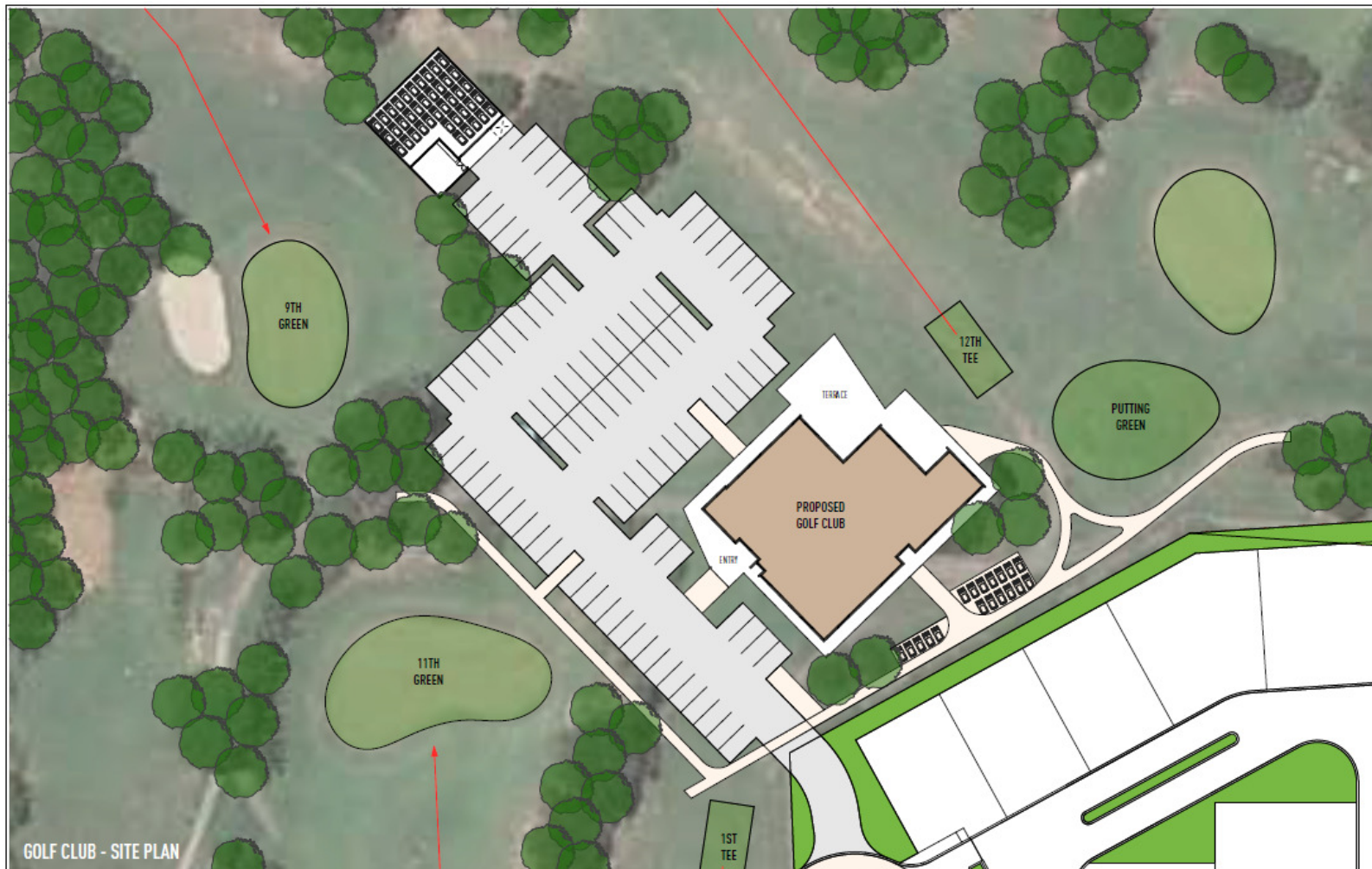

GOLF CLUB - SITE PLAN

NO.	REVISION
1	ISSUE FOR PERMIT

THE DRAWING AND ALL INFORMATION CONTAINED HEREIN ARE THE PROPERTY OF JARED POOLE DESIGN. NO PART OF THIS DRAWING IS TO BE REPRODUCED OR TRANSMITTED IN ANY FORM OR BY ANY MEANS, ELECTRONIC OR MECHANICAL, INCLUDING PHOTOCOPYING, RECORDING, OR BY ANY INFORMATION STORAGE AND RETRIEVAL SYSTEM, WITHOUT THE WRITTEN PERMISSION OF JARED POOLE DESIGN. THE CLIENT AGREES TO HOLD JARED POOLE DESIGN HARMLESS FROM AND AGAINST ALL CLAIMS, DAMAGES, LOSSES AND EXPENSES, INCLUDING REASONABLE ATTORNEY'S FEES, THAT MAY BE ASSERTED AGAINST OR INCURRED BY JARED POOLE DESIGN IN CONNECTION WITH THIS PROJECT.



PROJECT  
 PROPOSED NEW DEVELOPMENT  
 AT  
 LOT 2 & 3 MALL STREET, COOROY, QLD  
 FOR  
 GEMLIFE



JAREDPPOOLEDESIGN  
 LEVEL 1 25 SANDHURST DRIVE  
 COOROY, QLD 4370 AUSTRALIA  
 PHONE 67  
 1511 OR CAPTEL 07 4370 8888  
 FAX 67  
 1511  
 WWW.JPOOLEDESIGN.COM.AU

NO.	REVISION
1	ISSUE FOR PERMIT

**POOLE**

# Clubhouse Floorplan



ISSUE	DATE	DESCRIPTION
A	15.07.19	ISSUED FOR APPROVAL
B	08.08.19	REVISION TO GOLF CLUB APPROVAL AMENDMENT
C	27.09.19	REVISED DRAWING
D	02.10.19	FORWARDED TO LOCAL GOVERNMENT, DEFENDANCE, & PRO SHOP AREA INCORPORATED

• THE DRAWING HAS BEEN PREPARED IN ACCORDANCE WITH THE RULES OF ARCHITECTURE AND ENGINEERING AUSTRALIA (RAE) AND ALL APPLICABLE STANDARDS. THE DRAWING IS THE PROPERTY OF JARED POOLE DESIGN AND WILL NOT BE REPRODUCED OR TRANSMITTED IN ANY FORM OR BY ANY MEANS, ELECTRONIC OR MECHANICAL, INCLUDING PHOTOCOPYING, RECORDING, OR BY ANY INFORMATION STORAGE AND RETRIEVAL SYSTEM, WITHOUT THE WRITTEN PERMISSION OF JARED POOLE DESIGN.



PROJECT  
**PROPOSED NEW DEVELOPMENT**  
AT  
LOT 2 & 3 MYALL STREET, COORRY, QLD  
FOR  
**GEMLIFE**

**JAREDPPOLEDESIGN**  
LEVEL 1.05 ELKHORN AVENUE  
SURFERS PARADISE, Q. 4217 AUSTRALIA  
PRO DESIGN  
155 OF CAPITAL, Q. 4217 AUSTRALIA  
TEL: 07 5527 5800  
EMAIL: INFO@JPD.COM.AU  
WWW.JPD.COM.AU

DRAWN	CS	DRAWING NO.	GP1074/SK2.02
DATE	JAN 2019	ISSUE	D
SCALE	1:200 (R A3)	DRAWING: GOLF CLUB - DIMENSION PLAN	



# Clubhouse Perspectives



ENTRY PERSPECTIVE



GOLF COURSE PERSPECTIVE

NO.	DATE	DESCRIPTION
1	11/11/2024	Initial Design
2	11/11/2024	Final Design
3	11/11/2024	Final Design
4	11/11/2024	Final Design
5	11/11/2024	Final Design
6	11/11/2024	Final Design
7	11/11/2024	Final Design
8	11/11/2024	Final Design
9	11/11/2024	Final Design
10	11/11/2024	Final Design

ALL RIGHTS RESERVED. NO PART OF THIS DOCUMENT MAY BE REPRODUCED OR TRANSMITTED IN ANY FORM OR BY ANY MEANS, ELECTRONIC OR MECHANICAL, INCLUDING PHOTOCOPYING, RECORDING, OR BY ANY INFORMATION STORAGE AND RETRIEVAL SYSTEM, WITHOUT PERMISSION IN WRITING FROM POOLE ARCHITECTS, LLC.



PROPOSED NEW DEVELOPMENT  
 10000 W. 10TH AVENUE, SUITE 100  
 WEST JOLIET, ILLINOIS 61780  
 GEMLIFE

JARED POOLE ARCHITECTS  
 1000 W. 10TH AVENUE, SUITE 100  
 WEST JOLIET, ILLINOIS 61780  
 TEL: 815.741.1000  
 WWW.POOLEARCHITECTS.COM

NO.	DATE	DESCRIPTION
1	11/11/2024	Initial Design
2	11/11/2024	Final Design
3	11/11/2024	Final Design
4	11/11/2024	Final Design
5	11/11/2024	Final Design
6	11/11/2024	Final Design
7	11/11/2024	Final Design
8	11/11/2024	Final Design
9	11/11/2024	Final Design
10	11/11/2024	Final Design

**POOLE**

# Cart and Buggy Shed Plan

FOR APPROVAL  
NOT FOR CONSTRUCTION

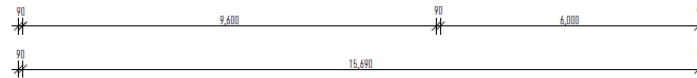

CART/BUGGY STORE - FLOOR PLAN

1:100 @ A3

NO.	DATE	DESCRIPTION
1	15/01/2019	FOR APPROVAL
2	15/01/2019	FOR APPROVAL

• THIS DRAWING HAS BEEN PRODUCED BASED ON INFORMATION SUPPLIED BY THE CLIENT. GEMLIFE ACCEPTS NO LIABILITY FOR THE ACCURACY OF THE INFORMATION PROVIDED. THE CLIENT SHALL BE RESPONSIBLE FOR THE ACCURACY OF THE INFORMATION PROVIDED. THE PROJECT ENGINEER SHALL NOT BE RESPONSIBLE FOR THE ACCURACY OF THE INFORMATION PROVIDED. THE PROJECT ENGINEER SHALL NOT BE RESPONSIBLE FOR THE ACCURACY OF THE INFORMATION PROVIDED. THE PROJECT ENGINEER SHALL NOT BE RESPONSIBLE FOR THE ACCURACY OF THE INFORMATION PROVIDED.



PROJECT  
PROPOSED NEW DEVELOPMENT  
AT  
LOT 2 & 3 MYALL STREET, COOROY, QLD  
FOR  
GEMLIFE

JAREDPPOOLDESIGN  
LEVEL 1 20 ELKHORN AVENUE  
SUNSHINE HILLS, QLD 4177 AUSTRALIA  
PO BOX 47  
ISLE OF CAPRA, QLD 4217 AUSTRALIA  
TEL: 07 5577 4300  
EMAIL: INFO@JPOLE.COM.AU  
WEB: WWW.JPOLE.COM.AU

SHOWN	CR	DRAWING NO.	ISSUE
DATE	JAN. 2019	BP1074/SK2.03	B
SCALE	1:100 @ A3		



# Proposed GemLife Resort Site Plan



### LEGEND

- STANDARD LOTS - 14m x 21m
- VILLA LOTS - 13m x 21m
- COMMUNITY LANDSCAPING
- EXISTING VEGETATION
- RETAINING WALL ZONE, REFER CIVILS

### YIELD

TOTAL NUMBER OF LOTS 246

### OPTIONS

- RELOCATABLE SALES SHOWROOM 0
- RV COMPOUND 0
- BOCCIE COURT 0

### GAIN/LOSS

- 0
- 0
- 0

MASTER PLAN 1500 @ A3

### PROPERTY DESCRIPTION

LOT 2 & 3 MYALL STREET COOROY QLD, 4543  
 LOT 2 & 3 ON SP115844  
 PARISH OF TEWANTIN  
 COUNTY OF MARCH  
 SITE AREA - 11,299 Ha  
 SITE COVER - 18%

ISSUE	DATE	DESCRIPTION
1	15/05/19	ISSUED FOR PERMIT
2	15/05/19	ISSUED FOR PERMIT
3	15/05/19	ISSUED FOR PERMIT
4	15/05/19	ISSUED FOR PERMIT
5	15/05/19	ISSUED FOR PERMIT
6	15/05/19	ISSUED FOR PERMIT
7	15/05/19	ISSUED FOR PERMIT

\* THE DRAWING HAS BEEN PREPARED BY THE ARCHITECTURE DIVISION OF THE LOCAL GOVERNMENT AND IS NOT TO BE USED FOR ANY OTHER PURPOSE WITHOUT THE WRITTEN PERMISSION OF THE ARCHITECTURE DIVISION.



PROJECT: PROPOSED NEW DEVELOPMENT  
 AT: LOT 2 & 3 MYALL STREET, COOROY, QLD  
 FOR: GEMLIFE

JAREDPPOLEDESIGN  
 LEVEL 1/35 ELANDER AVENUE  
 SUITE 101/101A, 4277 AUSTRALIA  
 PO BOX 42  
 4211 AUSTRALIA  
 TEL: 07 5577 5500  
 INFO@JPOLE.COM.AU  
 WWW.JPOLE.COM.AU

DRAWN	CHK	DRAWING NO.	ISSUE
JPOLE	JPOLE	BP1074/SK2.01	1

